

FIRE PROTECTION & WATERWORKS HANGERS

A 122 Underground Bell Clamp for Ductile Iron Pipe

Material: Carbon Steel

Application: Used as a safety device on a bell and spigot, or mechanical joint cast iron pipe where reversal stoppage or change in direction flow necessitates reinforcement. Two square plate washers supplied with each clamp.

Ordering: Specify figure number and pipe size.

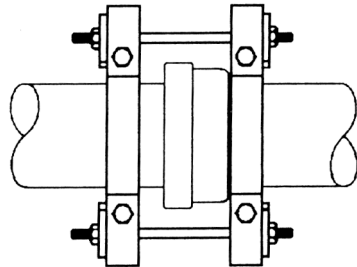
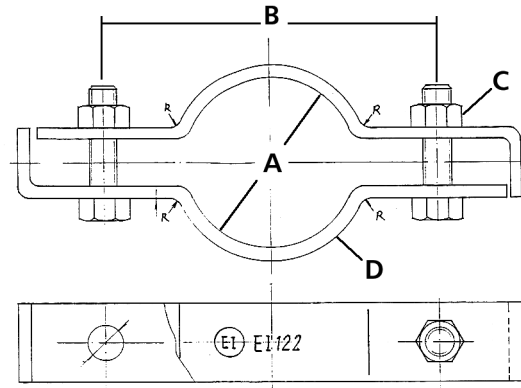

These clamps are all sized to accommodate Ductile Iron Pipe only.

A 122 UNDERGROUND BELL CLAMP FOR DUCTILE IRON PIPE

Size	A		B		C		D		Box Qty	
	mm	Pipe O.D.	mm	mm	mm	mm	mm	mm		
4	102	4.80	121.90	7-7/8	200	5/8	16	3/8x1-1/2	10x38	Bulk
6	152	6.90	175.30	10	256	5/8	16	3/8x1-1/2	10x38	Bulk
8	203	9.05	229.90	13	328	3/4	19	3/8x2	10x50	Bulk
10	254	11.10	281.90	15-7/8	382	3/4	19	1/2x2	12x50	Bulk
12	305	13.20	335.30	17-5/16	440	3/4	19	1/2x2	12x50	Bulk
14	356	15.30	388.60	19-11/16	500	7/8	22	5/8x3	16x76	Bulk
16	406	17.40	442.00	21-1/4	540	7/8	22	5/8x4	16x100	Bulk
18	457	19.50	495.30	23-5/8	600	1	25	5/8x4	16x100	Bulk

