

HANGER ATTACHMENTS AND STRUT PRODUCTS

A 22Z Zinc Plated Ceiling Flange

Material: Zinc Plated Malleable Iron.

Application: Designed for attaching to a wooden beam or structure where a hanger rod or threaded rod can be connected to support a pipe hanger.

Ordering: Specify figure number and rod size required.

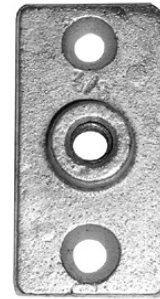
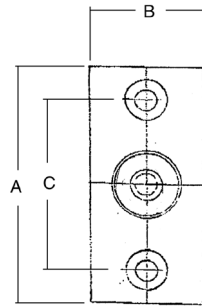

A 22Z CEILING FLANGE ZINC PLATED

SIZE		"A"		"B"		"C"		Max Rec Load	Box Qty
	mm		mm		mm		mm		
3/8	10	2-3/4	70	1-1/4	32	2	50	180	100
1/2	13	2-3/4	70	1-1/4	32	2	50	180	100

