

THREADED PRODUCTS

A 450 Steel Rod Couplings

Material: Zinc Plated Carbon Steel.

Application: Rod couplings are used to join two pieces of threaded rod together in order to support a pipe hanger holding pipe.

Ordering: Specify figure number and rod size required.

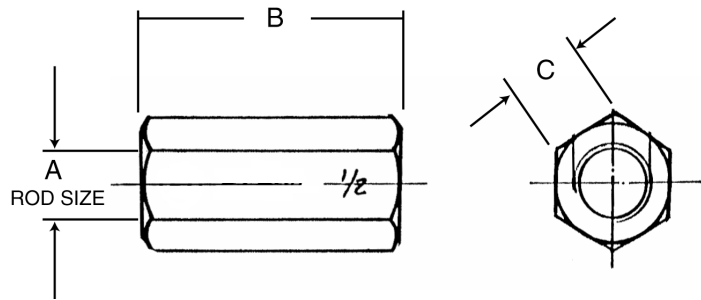

A 450 STEEL ROD COUPLINGS

SIZE		"A"		"B"		"C"		Box Qty
	mm		mm		mm		mm	
1/4	6	1/4	6	7/8	22	5/16	8	250
3/8	10	3/8	10	1-3/4	44	5/16	8	200
1/2	13	1/2	13	1-3/4	44	3/8	10	150
5/8	16	5/8	16	2	50	1/2	13	Bulk
3/4	19	3/4	19	2-1/4	57	9/16	14	Bulk
7/8	22	7/8	22	2-1/2	64	-	-	Bulk
1	25	1	25	2-1/2	64	-	-	Bulk
1-1/4	32	1-1/4	32	3	76	-	-	Bulk
1-1/2	38	1-1/2	38	3	76	-	-	Bulk

