

INDUSTRIAL HANGERS & CLAMPS

A 469 Standard Roller Chair

Material: Carbon Steel body, cast iron roller.

Application: Designed for supporting pipe with longitudinal movement. When this hanger is used with insulation a pipe protection saddle must be used.

Ordering: Specify figure number and pipe size. **When insulation is being used take diameter of pipe, plus two times the insulation thickness to arrive at actual size required.**

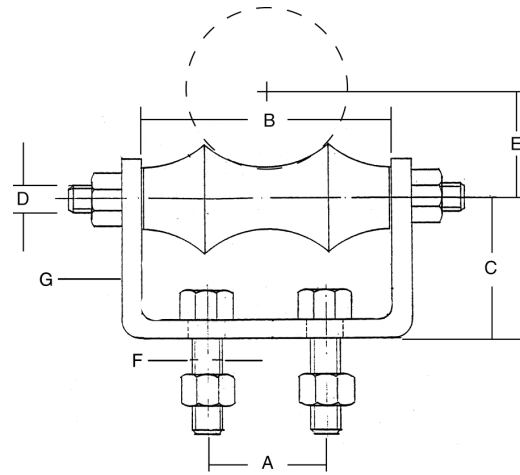

A 469 STANDARD ROLLER CHAIR

SIZE	A		B		C		D		E		F		G		Max Rec Load	
	mm	mm	mm	mm	mm	mm	mm	mm	mm	mm	mm	mm	mm			
1-1/2	38	1-1/2	38	3	76	1-1/2	38	3/8	10	1-3/8	34	3/8x1-1/2	10x38	1/4x1-1/4	6x32	390
2	50	1-1/2	38	3	82	1-3/4	44	1/2	13	1-5/8	40	3/8x1-1/2	10x38	1/4x1-1/4	6x32	390
2-1/2	64	1-1/2	38	3	82	1-3/4	44	1/2	13	1-7/8	47	3/8x1-1/2	10x38	1/4x1-1/4	6x32	390
3	76	2	50	3-7/8	99	1-3/4	44	1/2	13	2-1/8	53	3/8x1-1/2	10x38	1/4x1-1/4	6x32	390
3-1/2	89	2-1/2	64	4-7/8	126	2-1/2	64	5/8	16	2-9/16	64	1/2x1-1/2	13x38	3/8x1-1/2	10x38	390
4	102	2-1/2	64	4-7/8	126	2-1/2	64	5/8	16	2-13/16	70	1/2x1-1/2	13x38	3/8x1-1/2	10x38	950
5	127	3	76	6	152	2-1/2	64	5/8	16	3-7/16	87	1/2x1-1/2	13x38	3/8x1-1/2	10x38	950
6	152	3	76	7	178	2-3/4	70	3/4	19	4	102	1/2x1-1/2	13x38	3/8x2	10x50	950
8	203	3-1/2	88	9	229	3-3/4	95	7/8	22	5-1/8	130	5/8x1-1/2	16x38	3/8x2	10x50	2,100
10	254	5-1/4	133	11-1/8	283	4-1/8	105	7/8	22	6-3/8	162	5/8x2	16x50	1/2x2	12x50	2,100
12	305	5-1/2	140	13	330	4-3/8	111	7/8	22	7-7/16	189	5/8x2	16x50	1/2x2	12x50	2,400
14	356	6-1/2	165	14-1/2	368	5-1/4	133	1-1/8	28	8-3/8	213	3/4x2	19x50	1/2x2-1/2	12x64	3,130
16	406	8-1/4	210	16-1/2	419	5-5/8	143	1-1/4	32	9-3/8	238	3/4x2-1/2	19x64	1/2x3	12x76	3,970
18	457	9-1/4	235	18-1/2	470	6-3/4	171	1-1/4	32	10-1/2	267	3/4x2-1/2	19x64	1/2x3	12x76	4,200
20	508	10-1/4	260	20-3/4	552	7	178	1-3/8	34	11-5/8	295	3/4x2-1/2	19x64	1/2x3	12x76	4,550
24	610	12-1/4	310	24-3/4	629	7-7/8	200	1-1/2	38	13-7/8	352	7/8x3	22x76	5/8x4	16x102	6,160

